

Fingerprint Reader User Manual

Version: 2.2

Important Statement

Thank you for choosing Tufloc! Before using this product, please read this user manual carefully to avoid risks of danger to the users and those nearby and against damaging the device. Follow these instructions to ensure that your product functions properly.

Unless authorized by our company, no group or individual shall take excerpts of or copy all or part of these instructions nor transmit the contents of these instructions by any means.

The products described in this manual may include software that is copyrighted by our company and its possible licensors. No one may copy, publish, edit, take excerpts of, decompile, decode, reverse-engineer, rent, transfer, sublicense, or otherwise infringe upon the software copyright unless authorized by the copyright holder(s). This is subject to relevant laws prohibiting such restrictions.



As this product is regularly updated, we cannot guarantee exact consistency between the actual product and the written information in this manual. Our company claims no responsibility for any disputes that arise due to differences between the actual technical parameters and the descriptions in this document. The manual is subject to change without prior notice. The most up-to-date instructions will be available online at www.tufloc.com.

Table of Contents

1. Overview	1
2. Wire Connection.....	2
3. Operation Instructions	3
3.1 Recommended Steps for Usage	3
3.2 Administrator Operation.....	4
3.3 Adding/Editing Users	5
3.4 User Deletion	5
3.5 Registering Access Password	6
3.6 Deleting Access Password.....	6
3.7 Opening Lock.....	6
3.8 Unlocking Duration Configuration (default duration: 6s).....	7
3.9 Authentication Mode Configuration (default mode: FP/PW/RF)	7
Statement on the Right to Privacy, Warranty and Safety.....	8-11

1. Overview

Front view

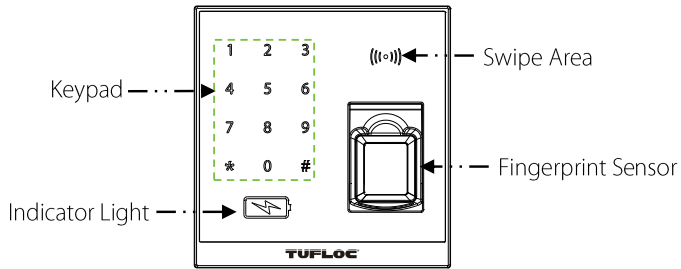

Rear view

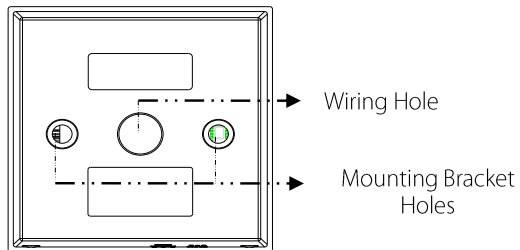

Bottom View

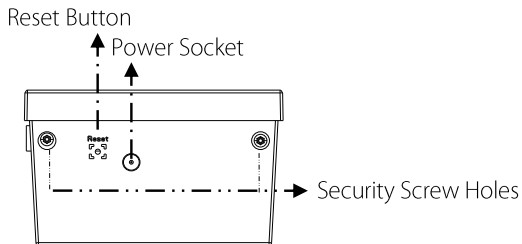

2. Wire Connection

This device comes with the battery already connected. The wire that will attach to the Lock should already be exposed as well.

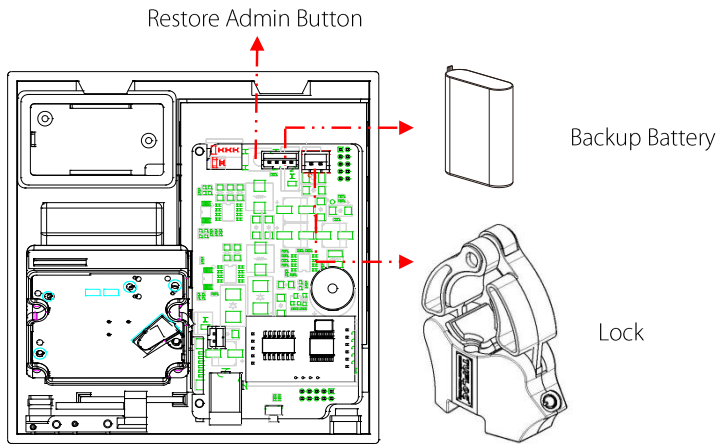

3. Operation Instructions

The device supports power or battery. A fully charged battery can power the device separately to work at least 8 hours or work on standby mode for 2 months.

- 1) The indicator light flashes blue in standby mode. It will stop flashing if without operation in 60 seconds.
- 2) When the indicator light flashes red, it indicates that the power of the battery is less than 20%. The indicator stops flashing red when it is charged to more than 20%.
- 3) If it is fully charged, the indicator flashes green continuously unless you unplug the power.

References

Key	{	[#] Confirm	Light	{	Green: Success	Digits	{	Password = 4 digits
		[*] Cancel	Status		Red: Failure			User ID ≤5 digits

Hint	{	Success: A long beep
tone		Failure: Two short beeps
		Error: Four short beeps

Note: After entering password/user ID, user must press [#] to confirm. Press [*] to return to initial state.

3.1 Recommended Steps for Usage

Step1: Enroll administrator using the default password and register fingerprint immediately.

Step2: You can register users, enroll cards, fingerprints or 8 passwords.

3.2 Administrator Operation

To ensure the data security of the device, users can operate the device only after the administrator password is authenticated.

✧ Registering Administrator Fingerprint

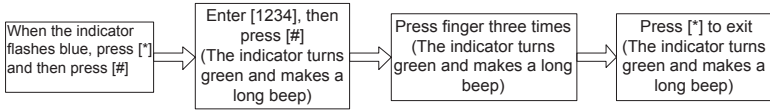

Note: The default administrator password is 1234. After administrator fingerprint (only can register one fingerprint) is registered successfully, the initial password will become invalid. If the administrator desires to become a user, they will have to register again, this time as a user. The administrator will not be able to open lock unless they register.

✧ Changing Administrator Fingerprint

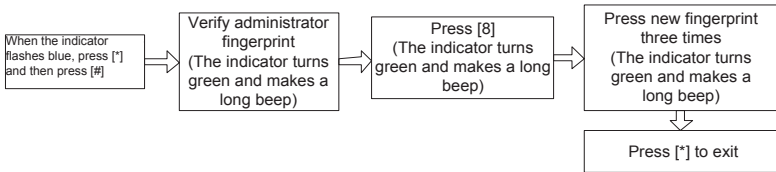

Lost Administrator Fingerprint

If the administrator fingerprint is lost, you can delete the administrator fingerprint by using “Restore Admin Button” (see diagram in Section 2).

Operation:

1. Wake up the device. When a long beep is heard, wait 30 seconds and press the “Restore Admin Button” four times within 10 seconds.
2. Device makes a long beep.

Note: This operation must be done within 1 minute.

When the operation is complete, the device will restore the default administrator password 1234.

3.3 Adding/Editing Users

Each user can register up to 10 fingerprints and 1 card.

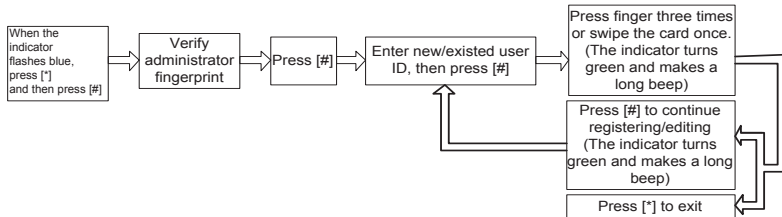

Note:

- ① After registering a fingerprint successfully, the indicator turns green and makes a long beep; you can continue to register other fingerprints, 10 at most.
- ② If the fingerprint or the card has been registered already or an error occurred while registering, the indicator turns red and generates four short beeps indicating that the registration failed. You can start registering the user again when the indicator turns green.
- ③ If the administrator fails in authentication in 3 attempts, please try again after 20 seconds.

3.4 User Deletion

✦ Deleting One User

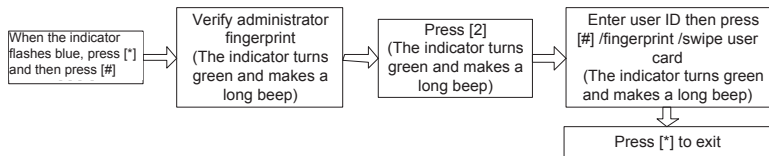

Note: After successful deletion, the device will automatically enter the process of deleting next user. Press [*] to exit.

❖ Deleting All Users

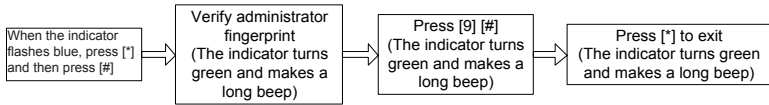

Note: Deleting all users does not include the passwords.

3.5 Registering Access Passwords

This device supports 8 passwords, each password has an ID ranging from 1~8.

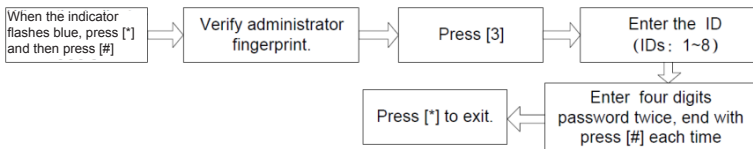

3.6 Deleting Access Password

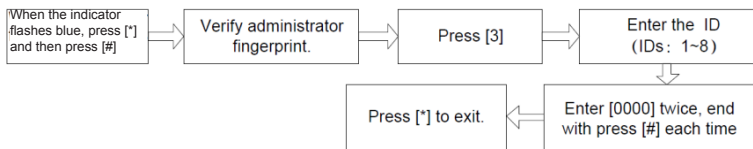

3.7 Opening Lock

Fingerprint/ Card/ Password Authentication

When the device is powered ON, it enters user authentication state (flashing blue light).

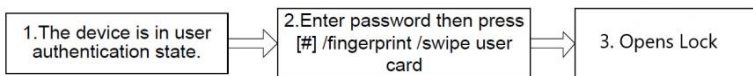

3.8 Unlocking Duration Configuration (default duration: 6s)

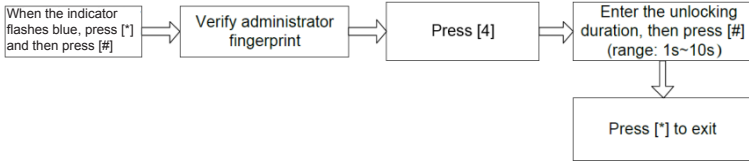

Note: Values greater than 10 will be considered invalid. The indicator turns red and makes four short beeps. It is recommended to use default settings. User can set according to actual needs.

3.9 Authentication Mode Configuration (default mode: FP/PW/RF)

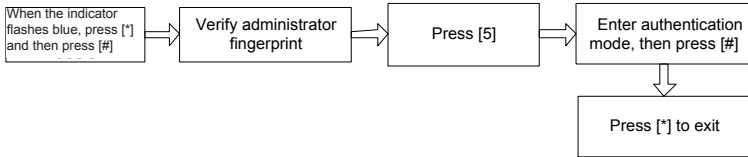

Note: Details of authentication modes are as follows:

Authentication Mode	Value	Description
PW	1	Only password verification
RF	2	Only RF card verification
FP	3	Only fingerprint verification
FP/PW/RF	4	Fingerprint or password or RF Card verification
RF&PW	5	RF Card and password verification (swipe card before entering password)
FP&PW	6	Fingerprint and password verification (fingerprinting before entering password)

Statement on the Right to Privacy

Dear Customers:

Thank you for choosing this biometric recognition product, which was designed and manufactured for Tufloc by ZKTeco. As a world-renowned provider of core biometric recognition technologies, ZKTeco is constantly developing and researching new products, and it strives to follow the privacy laws of each country in which the products are sold.

We Declare That:

1. All civilian fingerprint recognition devices capture characteristics, not fingerprint images, and do not involve privacy protection.
2. None of the fingerprint characteristics that we capture can be used to reconstruct an image of the original fingerprint, and do not involve privacy protection.
3. As the provider of this device, we will assume no direct or indirect responsibility for any consequences that may result from your use of this device.
4. If you would like to dispute human rights or privacy issues concerning your use of our product, please directly contact your employer.

Our other police fingerprinting devices or development tools can capture original images of citizens' fingerprints. As to whether this constitutes infringement of your rights, please contact your government or the final supplier of the device. As the manufacturers of the device, we will assume no legal liability.

ESMET INC. LIMITED WARRANTY

Esmet Inc., the manufacturer of Tufloc, warrants to the purchaser that the gun racks and accessories included in the packages offered for sale conform to the standards described on the product description page of our website and are free from defects in material and workmanship, *provided* that the item (1) has been installed, used and maintained properly in accordance with all written instructions and recommendations provided with the product; and (2) has not been damaged, altered, modified or repaired by any party other than Esmet Inc. To the fullest extent permitted by law, the limited warranty set forth on this page is the exclusive limited warranty, and in lieu of any other oral or written warranties or representations.

For additional information about our limited warranty, please visit our website at www.tufloc.com.

How Long Does the Coverage Last?

This limited warranty lasts for one (1) year from the date of purchase, or until you sell or otherwise transfer the gun rack, whichever comes earlier. Coverage terminates if you sell or otherwise transfer the item. The duration of any implied warranty, including the warranties of merchantability and fitness for a particular purpose, shall not exceed the duration of this written limited warranty.

What Will Esmet Inc. Do?

In the event that Esmet Inc. should determine within the warranty period that the item purchased is defective under the terms of this limited warranty, the purchaser's sole and exclusive remedy will be that Esmet Inc. will, at its option, repair or replace any defective or malfunctioning item at no cost to you. Within the warranty period, if Esmet Inc. is unable after a reasonable number of tries to repair the defective item, it will replace it with the same or a similar item.

What Does This Warrant Not Cover?

Any problem that is caused by abuse, misuse, *improper assembly of gun rack, modification of the gun rack or any of its components*, or an act of God is not covered. Esmet Inc. makes its best efforts to include just the right component parts in its packages. Some of the components selected are sourced from manufacturers other than Esmet Inc. Parts and products which are manufactured by companies other than Esmet Inc. and which are covered by a written warranty from the manufacturer of that part or product are not covered by this limited warranty. If your purchase of an Esmet gun rack includes a part or product manufactured by a company other than Esmet which is covered by a written warranty from the manufacturer, a copy of that written warranty will be provided to you by Esmet Inc. To the fullest extent permitted by law, Esmet Inc. shall not be liable to the purchaser, end user, or any third party for any indirect, special, incidental, or consequential damages. Some states do not allow the exclusion or limitation of incidental or consequential damages, so the above limitation or exclusion may not apply to you.

How Do You Get Service?

If something goes wrong with your item, contact customer service by phone or email at: 1-800-321-0870 or info@esmet.com

If necessary, we will inspect your item and contact you promptly to give the results of our inspection. If you authorize repairs, we will return the repaired item to you promptly. The cost of shipping the repaired item back to you will be paid by Esmet. If you inform us that you wish us to provide necessary parts to you, but that you wish to have repairs performed elsewhere, we will return the gun rack and/or replacement parts to you promptly. There is no charge for inspection.

How Does State Law Apply?

This limited warranty gives you specific legal rights, and you may also have other rights which vary from state to state.

IMPORTANT SAFETY PRECAUTIONS

The Esmet Inc. gun rack and components are designed and intended for the display, temporary storage and rapid release of firearms. The gun rack **does not** operate in such a way as to **prevent the firing of a chambered round or accidental discharge**. *DO NOT place a loaded gun in the rack. Always store the gun with the safety engaged.*

The safe use of the Esmet gun rack relies upon the following:

- Ensure that your firearm is the proper size for the gun rack. Certain modifications and add-ons, as well as adjustable or collapsible stocks, may interfere with the proper operation of the gun lock and/or rack.
- Carefully inspect the gun rack and components before installation.
- All components of the gun rack must be installed in strict conformance with the instructions and specifications provided. The components include: gun lock, mounting plate assembly, butt pocket and backplate. An optional fingerprint reader may also be used with the gun rack.

Users must familiarize themselves with the *training materials provided with the gun*, and with the operation of the gun rack, lock and optional fingerprint reader before use. *Additional information can be found at www.tufloc.com*

Tufloc
1406 Fifth St SW
Canton, OH 44702

Tel: 330-452-9132
Fax: 330-452-2557
www.tufloc.com